

2 "A" Rated Trials - Sanctioned by the JRTCA

June 11th & 12th, 2022

Payette County Fairgrounds

310 East Blvd., New Plymouth, ID



TRI-STATE
JACK RUSSELL TERRIER CLUB



**GO-TO-GROUND &
SUPER EARTH:**
Connie McKee &
Stephanie Poppe

RACING:
Aaron Pearson

CONFORMATION:
Stephanie Taylor - Sat
Stephen Darroch - Sun

URBAN WARFARE:
Jacob Trujillo

**TRAILING &
LOCATING:**
Aaron Pearson

BRUSH HUNT:
Bruce McCarthy

Chaired by the Tri-State Jack Russell Terrier Club Committee

Trial Administrators:

Susan Getty - gemdandyjrt@gmail.com & Lynn Hawley - lynn@forgetmenotjrt.com

Trial Secretary:
Deanna Gillette - plrjacks@gmail.com

Exhibitors and Owners of Terriers Entered Must Be Current JRTCA Members (Does not apply to other breeds)

GENERAL RULES FOR ALL EXHIBITORS

1. All sanctioned classes are open to Jack Russell Terriers only.
2. Exhibitors and owners of terriers entered must be current JRTCA members, and must not be a member of a conflicting JRT organization or register their JRTs in any all-breed registry or conflicting JRT registry. If an exhibitor is found to be in violation of this policy, entry will be disqualified and no refunds will be given. If a violation is confirmed after the trial, placements will be voided from all JRTCA records. Exhibitors must submit a completed entry form including a signed waiver for every trial they enter.
3. Entries MUST be within the 10-15" JRTCA height standard for all sanctioned classes (with the exception of pups who have not yet met the 10" height standard); measuring devices will be available on the trial grounds.
4. Puppies (under 12 months of age) are not eligible for a championship in any division but their own. Puppies are eligible to compete only if they have reached their four-month birthday (not 16 weeks). A puppy's age is the actual age the pup is on the day of the trial.
5. Bitches in season may not compete in any division. Pre-entry fees of bitches in season to be refunded with vet certificate from owner, or as otherwise agreed upon by the Trial Chairperson.
6. Spayed or neutered terriers may compete in Miscellaneous Conformation. They may not compete in Puppy, Family*, Open or Working Conformation. *Note: For Family Classes, Brood Bitches and Stud Dogs entered may not be spayed/neutered. The offspring at their sides may be intact or spayed/neutered.
7. A terrier bred by a sanctioned JRTCA Judge may not be shown under that Judge in the Conformation Division.
8. Terriers owned or co-owned by the Trial Chairperson, or any member of their household, may not be entered in any phase of the competition, with the exception of Child and Youth Handling classes.
9. Terriers owned by Judges may not be entered in the division in which they are judging, but may enter the competition in any other division.
10. Terriers owned by Stewards may be entered in any division provided that they find a substitute to perform their duties or have someone else show their terriers.
11. Requests for the measurement of a terrier entered in any class number may be made only by another exhibitor in that same class number or by the Judge EXCEPT in Racing. Requests for the measurement of a terrier in Racing may be made by the Judge or by an exhibitor with a terrier entered in the same class number; OR, if classes are split by gender, may call for the measurement of a terrier of the opposite gender in the same age and height category. (Example: The owner of an under adult dog entered in Racing may call for the measurement of an under adult bitch as the potential exists for them to race each other in the Championship Races.) Exhibitors racing puppies may call for the measurement of a puppy in a different age category as long as it is in the same height category. The person making the request for measurement must name the terrier or terriers they wish to have measured, but requests for measurement of entire classes will not be honored. The measurement of the terrier will be considered the terrier's official height for the duration of the trial. Only JRTCA height cards issued after September, 1999 will be honored.
12. Excessive use of squeaky or fur-like baiting devices by exhibitors is prohibited in the Conformation ring and may result in the exhibitor being excused from the class. "Excessive use" will be at the Judge's discretion.
13. Exhibitors participating in the JRTCA Working Terrier classes or Certificate Go-To-Ground/Super Earth must submit the appropriate JRTCA certificates with pre-entries or at the time of post-entry. The Judge may require a copy of the certificate be presented to the Ring/Den Steward at the time of judging. Registered terriers may submit a copy of NHC application signed by a JRTCA Working Judge within 30 days of the date it was issued.
14. Puppies under the age of three months are not permitted on the trial grounds. Any person violating this rule will be excused from all classes entered, and asked to leave the trial site. (This applies to RVs & campers, if at the same address as the trial grounds).
15. All dogs must be leashed or crated except when competition requires off leash work. No liberty leashes allowed
16. Overly aggressive dogs, or an owner's failure to control their dog, may result in disqualification at the discretion of the Judges or the Trial Chairperson.
17. The abuse of dogs or severe disciplining of dogs on the trial grounds is prohibited. Anyone displaying such behavior will be asked to leave the trial site, and no entry fees will be refunded.
18. Dogs other than JRTs on the grounds may be excluded or permitted at the discretion of the Trial Chairperson.
19. Exhibitors are responsible to double-check the classes they have entered and be on time. No refunds will be given for missed classes.
20. The owner/handler of a terrier entering any class does so at his/her own risk and agrees to abide by the rules of the JRTCA and the trial. A copy of the JRTCA Rule Book can be obtained by contacting the JRTCA office 410-561-3655; or it can be downloaded from the JRTCA website (www.therealjackrussell.com).
21. Unsportsmanlike conduct, or the use of foul and abusive language, will not be tolerated. Anyone demonstrating such conduct will be asked to leave the trial site and no entry fees will be refunded. In addition, such conduct will be subject to penalties, which may include the suspension of membership, restriction from entering the JRTCA National Trial, and/or fines. Trial Chairpersons have the right to refuse any entry at their sole and absolute discretion.
22. All dogs brought to JRTCA Sanctioned Trials must be current on vaccinations. No dogs of any age may be brought to a trial who have suspicion of contagious or infectious diseases.
23. Judges must not eat, smoke, or use cell phones while at their events. (01/22)
24. **THE JUDGE'S DECISION CONCERNING PLACEMENTS ARE FINAL IN ALL DIVISIONS!**

IMPORTANT TRIAL INFORMATION

Please familiarize yourself with the notes and rules listed below. Everything will run more smoothly if everyone knows the information provided.

As of Jan. 1, 2010, all competing terriers must be registered or recorded with the JRTCA. If your terrier has not been registered or recorded, you will have to pay an additional \$5.00 per dog per day. You still have to pay the normal \$2.00 per dog per day JRTCA Administration Fee. Both fees are turned in to the JRTCA.

*****ENTRIES MUST BE POSTMARKED BY
MONDAY, MAY 23, 2022*****

All entries postmarked after **5/23/2022** will be considered post-entries, and you will be charged accordingly. No Exceptions. NO PHONE ENTRIES. Please email entries to the Trial Secretary at plrjacks@gmail.com, (or regular mail - see entry form), along with copies of your current JRTCA Membership card, & any applicable Certificates. **EMAILED ENTRIES MUST BE RECEIVED BY FRIDAY, MAY 27TH**. All emailed entries will receive a confirmation email, if you have not received your confirmation by June 4, please contact the Trial Secretary.

CERTIFICATES: Please include copies of the necessary certificates with your pre-entries for the Working Division, GTG, Super Earth and any other class(es) requiring certificates. **The trial secretary makes no assumptions. If the appropriate certificate is not included, your dog will be entered in the open class -- NOT the certificate class.**

PLEASE REMEMBER TO PICK UP AFTER YOUR DOGS WHILE AT THE TRIAL SITE

If you see someone who does not, politely offer them a baggie.

REMINDER: Please follow the rules of your hotel/accommodations regarding your terriers; clean up after them on the grounds and please be a good representative of your club.

It is the intent of club members to provide a trial that is enjoyable for all participants. As a result, **UNSPORTSMANLIKE CONDUCT WILL NOT BE TOLERATED** at any time. Anyone demonstrating poor sportsmanship, rude behavior or causing trouble in any manner will be dismissed from all classes and asked to leave the trial grounds. No refunds will be given in this situation.

MEASUREMENTS of borderline-sized terriers or disputed terriers will be performed by a sanctioned judge a minimum of 30 minutes before **Racing** or **Conformation** starts. Conformation measurements will be performed by the Conformation judge or their designee **before** the start of Conformation classes. The judge, however, may call for a measurement once a class begins. Measurements made at this time will be considered the terriers' official height for the duration of the trial.

RINGSIDE SPACE: Available for the weekend for \$30.00 Members / \$35.00 Non-Members for a 10 X 10 space. Ringside Seating will be assigned. **ONLY 10 Spaces Available**. Reservations will be on a first come basis. There is plenty of open space to set up.

There are also 5' X 8' Stalls available inside of the Goat barn directly across from the Conformation Ring. Each Stall is \$5 for the weekend. Stalls will be assigned on a first come basis. X-pens are required inside the stall.

SPONSORSHIPS: Please sign up to sponsor a class. Sponsorships help pay for ribbons, trophies, judges and other trial expenses. See included sponsorship form.

VENDORS ARE WELCOME FOR THE WEEKEND! There is a \$25 fee. Please indicate on your entry form if you would like a vendor space.

VOLUNTEERS NEEDED – As with any trial, there is a lot of work involved. We appreciate any help with the many jobs needed to make this a successful trial. Please ask about volunteering by email or at the check-in table.

AWARDS will be given out throughout the weekend; there is no set award time.

RAFFLE – Details on page 23.

For their protection, **NO PUPPIES** under 3 months of age, or **BITCHES IN HEAT**, are allowed on the trial grounds **FOR ANY REASON**.

TRIAL AGENDA

TREASURE VALLEY GEMBOREE



TRI-STATE
JACK RUSSELL TERRIER CLUB

**** All Times Are Approximate ****

Every effort will be made to start Trial events on time.

FRIDAY – JUNE 10th

Trial Set-Up; **helpers are greatly appreciated** 9:00 AM – 12:00 PM
Early Check-in & Pick up Pre-registered Trial Packets, post-enter 2:00 – 4:00 PM

SATURDAY – JUNE 11th

Check-in (will be closed during racing)..... 11:00 AM – 2:00 PM

Post-Entries Accepted Until 2:00 PM

NO POST-ENTRIES ACCEPTED FOR RACING – EXCEPT TO FILL HEATS

Racing Meeting – at race track 8:15 AM
Racing Begins 8:30 AM
GTG and Super Earth 11:00 AM – 4:00 PM
Youth (after racing & awards)..... 11:00 AM
LUNCHapx. 12:30 PM
Conformation (after racing) 12:30 PM
Brush Hunt, Trailing & Locating, all other events apx. 11:00 AM – 4:00 PM
Awards throughout the day 4:30 PM
DINNER Onsite –Barbeque Chicken and Fixings. (see pg 7) 5:30 PM
Tri-State Club Annual General Meeting (at dinner) 6:00 PM

SUNDAY – JUNE 12th

Check-in (will be closed during racing)..... 9:00 AM – 3:00 PM
Racing Meeting – at race track 8:15 AM
Racing Begins 8:30 AM
GTG and Super Earth 11:00 AM – 4:00 PM
Youth 11:00 AM
LUNCHapx. 12:30 PM
Conformation (after racing) 12:30 PM
JRTRF Blood Draw (apx 1:00 pm to 4:00 pm) 1:00 PM
50/50 Raffle will be called (see pg 23) 3:30 PM
Brush Hunt, Trailing & Locating, all other events apx. 11:00 AM – 4:00 PM
Awards throughout the day 4:30 PM
Tear Down & Clean Up of Trial Site (**Please stay & volunteer to help**) 5:00 PM

Please pay attention to the scheduled times for each event and plan your schedule accordingly to ensure you are able to get to all the events you signed up for. The trial committee is not responsible for class conflicts that may arise and classes will not be held up for these conflicts. **There are no refunds for missed classes!**

Dogs late to racing or conformation will be scratched. Every effort has been made to schedule trial events such that exhibitors may enter as many classes as possible. However, several events must be run concurrently, thus some conflicts are unavoidable. **It is the responsibility of the EXHIBITOR to be aware of the scheduled classes and be on time for the classes they have entered.**

DIRECTIONS TO PAYETTE COUNTY FAIRGROUNDS

Driving Directions:

Payette County Fairgrounds
310 East Blvd, New Plymouth, ID



From the I-84 West

1. Merge onto I-84 E
2. Take exit 3 for US-95 toward Payette/Parma
3. Turn left onto US-95 N
4. Turn right onto US-30 E
5. Turn left onto E Idaho St
6. Turn right onto East Blvd
7. Destination will be on the left

From the I-84 East

1. Merge onto I-84 E
2. Take exit 17 toward Sand Hollow
3. Turn left onto Oasis Rd
4. Turn left to merge onto I-84 W/US-30 W toward Ontario
5. Take exit 9 for US-30 toward New Plymouth
6. Follow US-30 W to East Blvd in New Plymouth
7. Turn right onto US-30 W
8. Turn right onto SE Blvd/East Blvd
9. Continue to follow East Blvd
10. Destination will be on the right

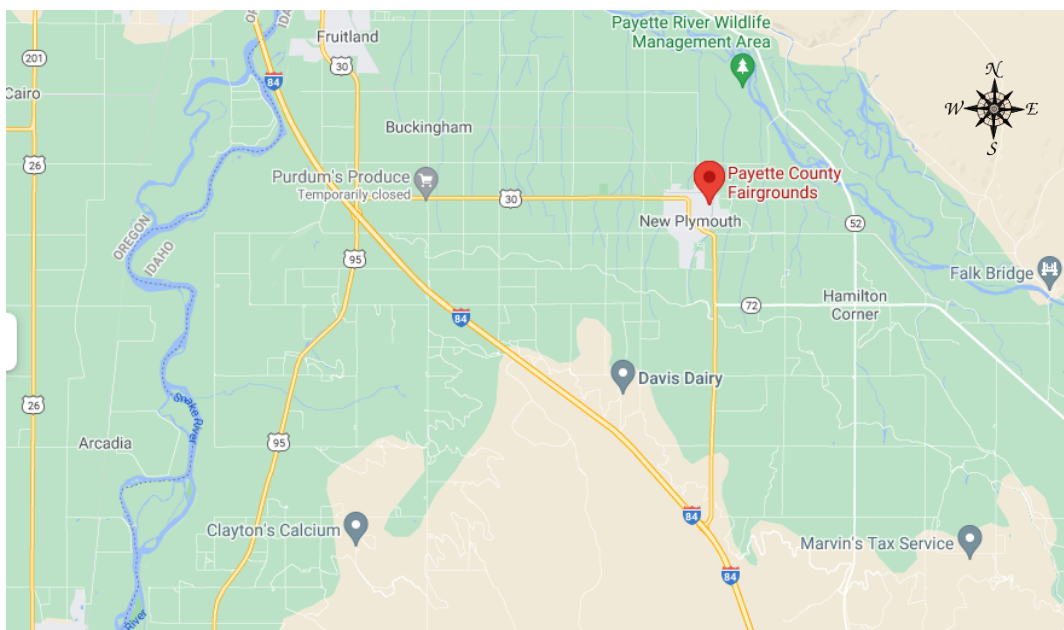

HOTELS

For Reservations – Please contact the hotel directly, mention you are with the TriState Jack Russell Terrier Club group. Reservations must be made before May 25th to get these deals.

Host Hotel: Quality Inn – Ontario
139 NE Goodfellow St. Ontario, OR. 97914

choicehotels.com/or247

(541) 889-9615

\$110 +tax per night double queen room, pet fees have been waived.

Holiday Inn Express
212 SE 10th Steet
Ontario, OR 97914

ihg.com

(208) 473-1521

5 Double Queen rooms for \$184 +tax

5 King rooms for \$169 +tax

Pet fees have been waived.

Red Lion Inn and Suites

266 Goodfellow Street,

Ontario, OR 97914

redlion.com

(541) 889-8282

We have the only 5 pet friendly rooms
blocked at this hotel. Rate is \$80 +tax.

Plus \$15 per night pet fee.

RV CAMPING

Payette County Fairgrounds (Trial Site)

20 Water & Electric hook-up sites (no sewer).

Sites are \$25 per night.

There is also ample dry camping within the
parking area. \$15 per night.

(208) 278-5000.

ALL SITES ARE FIRST COME

River Point RV Park

Ontario's newest park.

179 full hook-up sites.

225 SE 10th Street Ontario, OR 97914

541-449-7269

riverpointrvpark.com

Contact the park directly for reservations

YOU MUST RESERVE & PAY FOR YOUR CHOSEN FACILITY DIRECTLY; YOU ARE RESPONSIBLE FOR MAKING YOUR OWN RESERVATIONS. PLEASE MAKE SURE YOU REVIEW THEIR PRICES AND POLICIES. DO NOT SEND RESERVATIONS WITH ENTRIES. THEY WILL BE RETURNED.

VET SERVICES

Four Rivers Clinic

(541)889-7776

2280 SW 4th Ave., Ontario, OR

Emergency / After Hours

Mon-Saturday (541) 889-7776

(leave a message)



Eastern Oregon Animal Health

(541) 889-6711

1580 SW 4th St., Ontario, OR 97914

Dr. Tanya Percifield

WestVet

24/7 Emergency Vet (208) 375-1600

5024 W Chinden Blvd., Garden City, ID

westvet.net

ONSITE EATS

Saturday Lunch – is provided by Garbonzos Pizza, a local favorite! Lunch includes a Garbonzos BIG slice of your choice of: All Meat, Combination, or Vegetarian Pizza, two of their delicious Bread Sticks and a Small Garden Salad. \$15 delivered to the trial site. You must **PRE-ORDER & PAY** on your entry form.



SATURDAY NIGHT DINNER

Join us Saturday evening after conformation, June 11, 2022 onsite, for an All You Want dinner. Presented by Chefs Shelli and Joanie of Spritely JRT / Sweets For You.

Dine on Barbecued Chicken Quarters, Potato Salad & Green Salad, Garlic Rosemary Beans, Fresh Asparagus with Truffle Vinaigrette, Homemade Bread, and a Death by Chocolate (gluten free) Dessert. \$20 fills you up! **PLEASE RSVP & PAY ON YOUR ENTRY FORM**

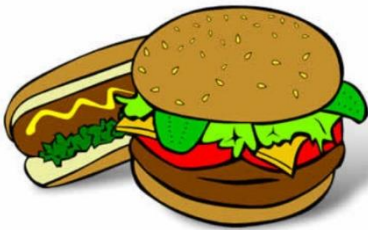

Sunday Lunch – DooWops Barbeque trailer will be on site at 11:00 am grilling up their world-famous fare! **PRE-ORDER & PAY** for your choice of a Hamburger, Polish Dog, Chorizo Dog or a Veggie Burger. Served with a bag of chips. They will have a limited number of additional lunches available if you just can't get enough. \$12

BEST LOCAL EATS

[Brewsky's Broiler](#) (541) 889-3700 [Menu](#)
23 SE 1st Ave., Ontario, OR
Open Monday-Saturday 11-10
Closed Sundays

[Fiesta Guadalajara](#) (541) 889-8064 [Menu](#)
336 S Oregon St., Ontario, OR 97914
Open 11-10pm Daily

[Ogawa's](#) Wicked Sushi, Burgers, & Bowls [Menu](#)
(208) 452-6517 900 NW 13th St., Fruitland, ID
Tuesday - Friday: 11:00 am - 9:00 pm
Saturday: 12:00 pm - 9:00 pm
Closed Sunday - Monday



[Plaza Inn](#) (541) 889-3550 [Menu](#)
812 SW 4th Ave., Ontario, OR
Monday – Friday 7AM to 7 PM
Saturday – 7 AM to 5 PM
Sunday – 7 AM to 4 PM

[Black Cow](#) (208) 230-5201
805 NW 3rd St., Fruitland, ID
Monday - Friday 7am to 2 pm
Saturday – 8am to 2 pm
Closed Sundays

[Wingers](#) (541) 881-0062 [Menu](#)
1255 SE 1st Ave, Ontario, OR
Sunday – Thursday 11:00 AM – 10:00 PM
Friday – Saturday 11:00 AM – 10:30 PM



Tri-State Jack Russell Terrier Club Treasure Valley Gemboree Trial Site:

Payette County Fairgrounds
310 East Blvd.
New Plymouth, ID
(208) 278-5000

Map of Fairgrounds

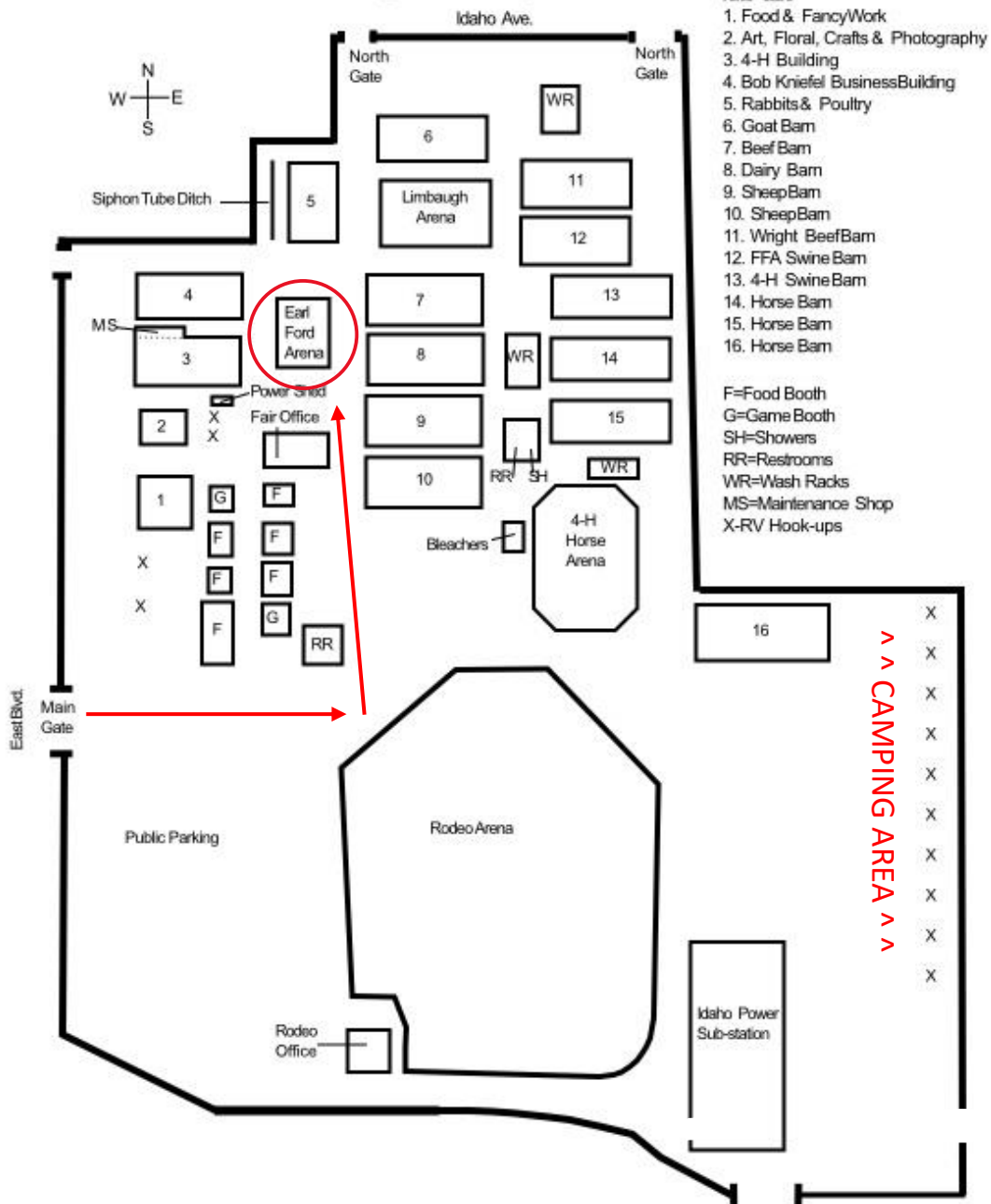

DIVISION A: RACING

- **ALL TERRIERS MUST BE MUZZLED!** Plastic basket muzzles or closed-ended cloth muzzles ONLY. **Figure eight, open-ended, and Baskerville muzzles are NOT allowed, No exceptions.**
- **ATTENTION: JRTCA RULE FOR RACING MUZZLES – NO COLORED MUZZLES ALLOWED. White, Black, Brown/Tan, & Clear muzzles are allowed.**
- Terriers MUST ENTER both flats & hurdles AND FINISH in both, at least one flat race AND one hurdle race and place first in at least one of their finals to compete in Championship races.
- Seniors run over low hurdles, up to 8 inches.
- No cross-entering between regular Adult classes, Veteran classes, Senior classes, or sanctioned and non-sanctioned classes.
- Races will be run in the sequence posted in this Trial Premium.
- **Please HAVE YOUR TERRIER ON DECK AND MUZZLED. Please listen for class announcements! If you need assistance please ask; we are here to help.**
- **PLEASE BE CONSIDERATE OF OTHER COMPETITORS.**
- **3-4 and 4-6 month puppies do not run hurdles or qualify for Puppy Championship.**

Section 1. Flat Races

Class 1	Pups , 3 to 4 months (Pups must meet onsite age requirement, See Pg 2, Rule 14)	Non-Sanc
Class 2	Pups , 4 to 6 months	Non-Sanc
Class 3	Pups , 6 up to 9 months, up to 12 ½"	
Class 4	Pups , 6 up to 9 months, over 12 ½" up to 15"	
Class 5	Pups , 9 up to 12 months, up to 12 ½"	
Class 6	Pups , 9 up to 12 months, over 12 ½" up to 15"	
Class 7	Dogs , 1 year and older, 10" up to 12 ½"	
Class 8	Dogs , 1 year and older, over 12 ½" up to 15"	
Class 9	Bitches , 1 year and older, 10" up to 12 ½"	
Class 10	Bitches , 1 year and older, over 12 ½" up to 15"	
Class 11	Veteran Dogs , 6 years and older, 10" up to 12 ½"	
Class 12	Veteran Dogs , 6 years and older, over 12 ½" up to 15"	
Class 13	Veteran Bitches , 6 years and older, 10" up to 12 ½"	
Class 14	Veteran Bitches , 6 years and older, over 12 ½" up to 15"	
Class 15	Senior Dogs , 9 years and older, 10" up to 12 ½"	
Class 16	Senior Dogs , 9 years and older, over 12 ½" up to 15"	
Class 17	Senior Bitches , 9 years and older, 10" up to 12 ½"	
Class 18	Senior Bitches , 9 years and older, over 12 ½" up to 15"	
Class 19	Other Breed , Open to any breed other than a JRT up to 12 ½"	Non-Sanc
Class 20	Other Breed , Open to any breed other than a JRT over 12 ½" up to 15"	Non-Sanc

Section 2. Steeplechase Races

Puppy and Senior terriers race over low hurdles, up to 8". We run the Steeplechase and Championship races for the Puppy and Senior classes back-to-back since they use the same 8" jump height limit. Adult and Veteran Races over higher hurdles, over 8" up to 16". **No 3-4 or 4-6 month Puppy Steeplechase Races.**

Class 21	Pups , 6 up to 9 months, up to 12 ½"
Class 22	Pups , 6 up to 9 months, over 12 ½" up to 15"
Class 23	Pups , 9 up to 12 months, up to 12 ½"

- Class 24 **Pups**, 9 up to 12 months, over 12 ½" up to 15"
- Class 25 **Senior Dogs**, 9 years and older, 10" up to 12 ½"
- Class 26 **Senior Dogs**, 9 years and older, over 12 ½" up to 15"
- Class 27 **Senior Bitches**, 9 years and older, 10" up to 12 ½"
- Class 28 **Senior Bitches**, 9 years and older, over 12 ½" up to 15"
- Class 29 **Up to 12 ½" PUPPY RACING CHAMPIONSHIP**. Open to the 1st place winners of classes 3, 5, 21 & 23. **No Entry Fee**
- Class 30 **Over 12 ½" up to 15" PUPPY RACING CHAMPIONSHIP**. Open to the 1st place winners of classes 4, 6, 22, & 24. **No Entry Fee.**
- Class 31 **10" Up To 12 ½" SENIOR RACING CHAMPIONSHIP**. Open to the 1st place winners of Classes 15, 17, 25 & 27. **No entry fee**
- Class 32 **Over 12 ½" Up To 15" SENIOR RACING CHAMPIONSHIP**. Open to the 1st place winners of Classes 16, 18, 26 & 28. **No entry fee.**

(Races are over higher hurdles, over 8" up to 16")

- Class 33 **Dogs**, 1 year and older, 10" up to 12½"
- Class 34 **Dogs**, 1 year and older, over 12½" up to 15"
- Class 35 **Bitches**, 1 year and older, 10" up to 12½"
- Class 36 **Bitches**, 1 year and older, over 12½" up to 15"
- Class 37 **Veteran Dogs**, 6 years and older, 10" up to 12½"
- Class 38 **Veteran Dogs**, 6 years and older, over 12½" up to 15"
- Class 39 **Veteran Bitches**, 6 years and older, 10" up to 12½"
- Class 40 **Veteran Bitches**, 6 years and older, over 12½" up to 15"
- Class 41 **Other Breed**, Open to any breed other than a JRT up to 12 ½"
- Class 42 **Other Breed**, Open to any breed other than a JRT over 12 ½" up to 15"
- Class 43 **10" up to 12 ½" ADULT RACING CHAMPIONSHIP**. Open to the 1st place winners of classes 7, 9, 33 & 35. **No Entry Fee.**
- Class 44 **Over 12 ½" up to 15" ADULT RACING CHAMPIONSHIP**. Open to the 1st place winners of classes 8, 10, 34 & 36. **No Entry Fee.**
- Class 45 **10" up to 12 ½", VETERANS RACING CHAMPIONSHIP**. Open to the 1st place winners of classes 11, 13, 37 & 39. **No Entry Fee.**
- Class 46 **Over 12 ½" up to 15", VETERANS RACING CHAMPIONSHIP**. Open to the 1st place winners of classes 12, 14, 38 & 40. **No Entry Fee.**

**Non-Sanc
Non-Sanc**

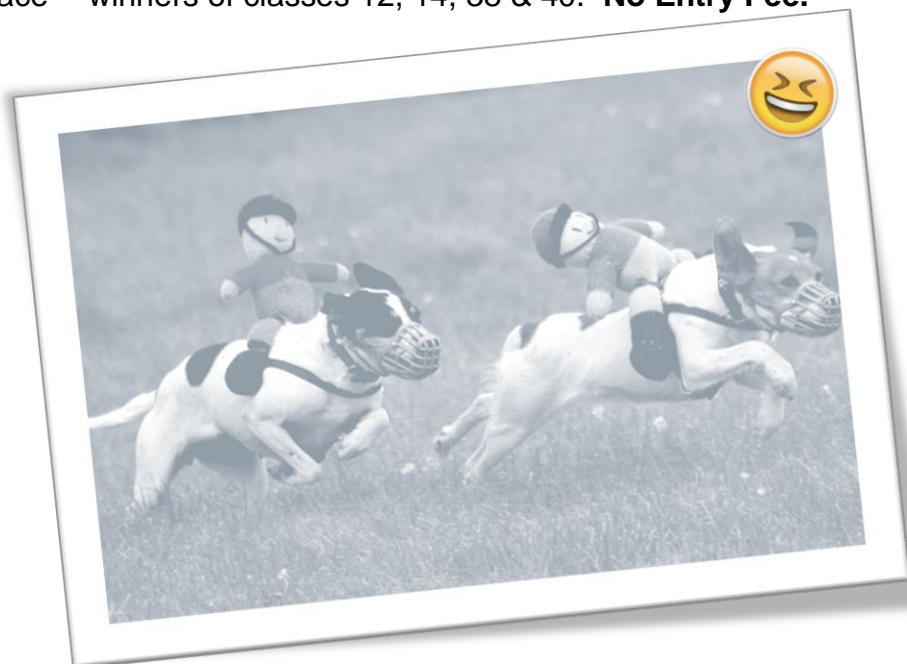

DIVISION B: CHILD & YOUTH

All Child/Youth Classes Sponsored by Desi Blondeel-Timmerman

Child and Youth Handler classes will be the first Conformation classes in the ring. Child Handler will go first followed by Youth Handler, then Conformation.

The Child/Youth Handler program must handle the SAME terrier in all the Child/Youth Division classes entered. The intention of this Division is for the Child/Youth to have a positive experience. They should have a basic knowledge of the history of the Jack Russell Terrier as well. This information is available on the Jack Russell Terrier Club Of America's website. www.therealjackrussell.com.

Go-To-Ground

For those terriers entered in the Child/Youth Handler Division and in the Go-To-Ground Division, please remember that the terrier **MUST** run their **SANCTIONED** Go-To-Ground class **BEFORE** the Child/Youth Handler Go-To-Ground class(es).

Reminder!

- Class 47 **Child Handler** – Open to any youth aged 5 through 9, handling a Jack Russell Terrier, six months of age or older. This class is offered as an introductory experience in handling and learning about the Jack Russell Terrier. Judged on the child's ability to present his/her dog and beginning knowledge of the Jack Russell Terrier. Quality of terrier is NOT to be considered.
- Class 48 **Child Go-To-Ground (NON-SANCTIONED)** – Open to any youth aged 5 through 9, handling a Jack Russell Terrier, six months of age or older. Judged on the child's ability to present his/her dog and knowledge of Go-To-Ground. To be run through the 10- foot Novice liner; time not to be considered **Non-Sanc**
- Class 49 **CHILD HANDLER HIGH SCORE & RESERVE (NON-SANCTIONED)** – **Awarded to the highest scoring child and runner-up in Classes 47 & 48.** The points are awarded as follows: 1st=8 points, 2nd=6 points, 3rd=5 points, 4th=4 points, 5th=3 points, 6th=2 points; and participation = 1 point. **No Entry Fee** **Non-Sanc**
- Class 50 **Youth Handler** – Open to any youth aged 10 through 16, handling an adult Jack Russell Terrier. Judged on the youth's ability to present his/her dog and knowledge of the Jack Russell Terrier.
- Class 51 **Youth Go-To-Ground** – Open to any youth aged 10 through 16, handling a Jack Russell Terrier. Judged on the youth's ability to present his/her dog and knowledge of Go-To-Ground. To be run through the 10-foot Novice liner; time not to be considered.
- Class 52 **YOUTH HANDLER HIGH SCORE & RESERVE** – **Awarded to the highest scoring youth and runner-up in Classes 50 & 51.** The points are awarded as follows: 1st=8 points, 2nd=6 points, 3rd=5 points, 4th=4 points, 5th=3 points, 6th=2 points; and participation = 1 point. **No Entry Fee**

NOTE: Child Handlers must compete in Child Handler & Child GTG to qualify for Child Handler High Score & Reserve. Youth Handlers must compete in Youth Handler & Youth GTG to qualify for Youth Handler High Score & Reserve.

In the event of a tie, it will be broken by a handling class to be held in the Conformation Ring; the Judge to be decided by the Trial Administrator.

DIVISION C: CONFORMATION

Section 1. JRTCA Working Terrier Conformation

Open to any JRTCA registered terrier owned by a JRTCA member which holds a JRTCA Natural Hunting Certificate (NHC). Terriers entering the Working Section may not cross-enter into the Open Section; no cross-entering is permitted within the Working Section.

- Class 53 **Bronze Medallion Dog** – Open to any dog which has earned the JRTCA Bronze Medallion for Special Merit in the Field.
- Class 54 **Bred by Exhibitor Working Terrier Dog** – Open to any Working Jack Russell Terrier owned and bred by the exhibitor under whose kennel prefix the terrier is registered; must be handled by the breeder or a member of the breeder's immediate family.
- Class 55 **Working Terrier Dog**, 10" up to 12.5"
- Class 56 **Working Terrier Dog**, over 12.5" up to 15"
- Class 57 **Working Veteran Dog**, open to any dog 6 years of age and older
- Class 58 **Best Working Terrier Dog & Reserve – Open to 1st and 2nd place winners of Classes 53-57. No Entry Fee.**
- Class 59 **Bronze Medallion Bitch** – Open to any bitch which has earned the JRTCA Bronze Medallion for Special Merit In The Field.
- Class 60 **Bred by Exhibitor Working Terrier Bitch** – Open to any Working Jack Russell Terrier owned and bred by the exhibitor under whose kennel prefix the terrier is registered; must be handled by the breeder or a member of the breeder's immediate family.
- Class 61 **Working Terrier Bitch**, 10" up to 12.5"
- Class 62 **Working Terrier Bitch**, over 12.5" up to 15"
- Class 63 **Working Veteran Bitch**, open to any bitch 6 years and older
- Class 64 **Best Working Terrier Bitch & Reserve – Open to 1st and 2nd place winners of Classes 59-63. No Entry Fee.**
- Class 65 **WORKING TERRIER CONFORMATION CHAMPION & RESERVE – Open to 1st and 2nd place winners of Classes 58 & 64. No Entry Fee.**

Section 2. Puppy Conformation

- Class 66 **3 Month Up To 4 Month Puppies**, 3 up to 4 months. Puppies must meet onsite age qualifications to participate, see Rule 14, pg 2. **(Non-Sanctioned)** **Non-Sanc**

4 Up To 6 Month Puppy Conformation

- Class 67 **Dog Pups**, 4 up to 6 months
- Class 68 **Bitch Pups**, 4 up to 6 months
- Class 69 **Best 4-6 Month Puppy & Reserve – Open to the 1st and 2nd place winners of Class 67 & 68. No Entry Fee.**



6-12 Month Puppy Conformation

- Class 70 **Dog Pups**, 6 up to 9 months
- Class 71 **Dog Pups**, 9 up to 12 months
- Class 72 **Best Puppy Dog & Reserve – Open to 1st and 2nd place winners of Classes 70 & 71. No Entry Fee.**
- Class 73 **Bitch Pups**, 6 up to 9 months
- Class 74 **Bitch Pups**, 9 up to 12 months
- Class 75 **Best Puppy Bitch & Reserve – Open to 1st and 2nd place winners of Classes 73 & 74. No Entry Fee.**
- Class 76 **PUPPY CONFORMATION CHAMPION & RESERVE – Open to 1st and 2nd place winners of Classes 72 & 75. No Entry Fee.**

Section 3. Open Adult Conformation

No cross-entering is permitted within the Open Section. Cross-entering is not permitted between the Open Section and the Working Section.

- Class 77 **Bred By Exhibitor Dog – Open to any adult JRT owned and bred by the exhibitor; must be handled by the breeder under whose kennel prefix the terrier is registered to or a member of the breeder's immediate family.**
- Class 78 **Dogs, 1 year and older, 10" up to 12.5", smooth**
- Class 79 **Dogs, 1 year and older, 10" up to 12.5", rough/broken**
- Class 80 **Dogs, 1 year and older, over 12.5" up to 15", smooth**
- Class 81 **Dogs, 1 year and older, over 12.5" up to 15", rough/broken**
- Class 82 **BEST DOG & RESERVE – Open to 1st and 2nd place winners of Classes 77-81. No Entry Fee.**
- Class 83 **Bred By Exhibitor Bitch – Open to any adult Jack Russell Terrier owned and bred by the exhibitor; must be handled by the breeder under whose kennel prefix the terrier is registered or a member of the breeder's immediate family.**
- Class 84 **Bitches, 1 year and older, 10" up to 12.5", smooth**
- Class 85 **Bitches, 1 year and older, 10" up to 12.5", rough/broken**
- Class 86 **Bitches, 1 year and older, over 12.5" up to 15", smooth**
- Class 87 **Bitches, 1 year and older, over 12.5" up to 15", rough/broken**
- Class 88 **BEST BITCH & RESERVE – Open to 1st and 2nd place winners of Classes 83-87. No Entry Fee.**
- Class 89 **BEST OPEN TERRIER & RESERVE – Open to 1st and 2nd place winners of Classes 82 & 88. No Entry Fee.**

Section 4. Breeders' Classes

Open to Stud Dog and Get and Brood Bitch and Produce. Must have at least two, but no more than three offspring at parent's side. Stud Dog and Brood Bitch must be intact. Offspring may be intact or spayed/neutered. Judged on Breed Standard and consistency of type.

Class 90 **Stud Dog & Get**

Class 91 **Brood Bitch & Produce**

Class 92 **BEST FAMILY & RESERVE – Open to 1st and 2nd place winners from Classes 90 & 91. No Entry Fee.** **Non-sanc**

Section 5. Miscellaneous

(SANCTIONED UNLESS NOTED)

Open to any adult Jack Russell Terrier including those spayed and neutered. Those that are intact may enter the Miscellaneous Classes and may cross-enter into regular Conformation. Judged on breed standard and condition of the dog, unless otherwise noted.

Class 93 **Novice Terrier** – Open to any adult JRT which has never placed 1st - 4th in an adult regular or 1st in any Novice Conformation Class at this or ANY prior sanctioned trial).

Class 94 **Spayed/Neutered Working Terrier** – Open to any adult spayed/neutered JRT which holds a JRTCA Natural Hunting Certificate. NHC to be provided with entry form or at time of class.

Class 95 **Spayed/Neutered Terrier** – Open to any adult JRT which has been neutered or spayed).

Class 96 **Veteran Terrier** – Open to any JRT 6 years and older. Judged on Breed Standard and condition of the terrier. (Applies to Veteran & Senior High Point)

Class 97 **Companion & Rescue Terrier** – Open to any Jack Russell Terrier or working breed AND/OR any rescue or foster dog. (Qualifies for the Companion & Rescue High Point) **Non-Sanc**

Class 98 **BEST MISCELLANEOUS TERRIER & RESERVE – Open to the 1st and 2nd place winners from classes 93 – 97. No Entry Fee.** (Non-Sanctioned) **Non-Sanc**

Class 99 **Other Breed, Judge's Choice up to 12 ½"** – Open to any adult "other breed", up to 12 ½", up to 30 lbs. (Non-Sanctioned). **Non-Sanc**

Class 100 **Other Breed, Judge's Choice over 12 ½"** – Open to any adult "other breed", over 12 ½", up to 30 lbs. (Non-Sanctioned). **Non-Sanc**

Class 101 **BEST OTHER BREED & RESERVE – Open to the 1st and 2nd place winners from classes 99 & 100. No Entry Fee.** (Non-Sanctioned) **Non-Sanc**

Section 6. Suitability – Judge’s Choice

(SANCTIONED)

Open to any adult Jack Russell Terrier, including those which have been spayed/neutered. The dog the Judge would choose to take hunting to each quarry listed below.

Class 102 **Suitability to Red Fox**

Class 103 **Suitability to Groundhog**

Class 104 **Suitability to Raccoon/Badger**

Class 105 **BEST SUITABILITY & RESERVE – Open to 1st and 2nd place winners from classes 102-104. No entry fee.**

DIVISION D: GO-TO-GROUND

Section 1. Open Go-To-Ground (Sanctioned, unless otherwise noted)

Class 106 **Pre-Novice Puppy** – Open to Jack Russell puppies 4 to 6 months of age. Entry in Pre-Novice Puppy class does not affect the puppy’s eligibility to enter the Novice class after 6 months of age. (One minute to reach quarry; may leave earth and re-enter until quarry is reached; mark quarry for 15 seconds without a break in work and without leaving quarry.)

Class 107 **Novice Puppy** – Open to Jack Russells 6 up to 12 months which have not scored 100% in this class at a previous JRTCA trial. Entries earning a score of 100% at this trial may, upon payment of the entry fee, enter the Open Puppy Class at this trial. (One minute to reach quarry; may leave earth and re-enter several times until quarry is reached; when quarry is reached, must work quarry continuously for a full 30 seconds without break in work and without leaving the quarry; may switch from one type of work to another -- examples: baying to concentrated stare or digging to baying.)

Class 108 **Open Puppy** – Open to Jack Russells 6 to 12 months which have scored 100% in a Novice Go-To-Ground class at this or a previous JRTCA trial. Puppies earning a score of 100% at this trial may, upon payment of the entry fee, enter the Puppy Championship GTG class at this trial **OR** may continue competing in Open Puppy Go to Ground class at future trials. **Open Puppy GTG is not open to any Puppy which has competed in Puppy Championship GTG. (01/22)**. (One second per foot of tunnel to reach quarry; may leave earth once and re-enter before quarry is reached; must work quarry continuously for one full minute without a break in work and without leaving quarry; may switch from one kind of work to another).

Class 109 **PUPPY CHAMPIONSHIP** – Open to Jack Russells 6 up to 12 months which have earned 100% in an Open Go-To-Ground class at this or a previous JRTCA trial. A copy of a 100% Open score sheet shall be submitted with pre-entry or be shown to the Den Steward at the time of the class. First and second place winners will be Puppy Go-To-Ground Champion and Reserve. (One second per foot of tunnel to reach quarry; may leave earth once and re-enter before quarry is reached; when quarry is reached must work quarry continuously for one full minute without a break in work and with-out leaving quarry; may switch from one kind of work to another.)

Class 110 **Novice Adult** – Open to JRTs 1 year or older which have not scored 100% in this class at a previous JRTCA trial. Entries earning a score of 100% at this trial may, upon payment of entry fee, enter the Open class at this trial. (One minute to reach quarry; may leave earth and re-enter several times until quarry is reached; must work quarry continuously for a full 30 seconds without break in work and without leaving the quarry; may switch from one type of work to another -- examples: baying to concentrated stare or digging to baying.)

NOTE: If a terrier has passed the Novice Puppy class or Novice Adult class, the terrier may not enter ANY Novice class ever again.

Class 111 **Open Adult** – Open to Jack Russells 1 year or older which have scored 100% in a Novice Go-To-Ground class at this or a previous JRTCA trial. (One second per foot of tunnel to reach quarry; may leave earth once and re-enter before the quarry is reached; must work quarry continuously for one full minute without a break in work and without leaving quarry; may switch from one kind of work to another)

Class 112 **Other Breed Go-To-Ground – up to 12 ½" (Non-Sanctioned)** – Open to any breed other than a JRT, under 30 lbs. May Not cross-enter with any Sanctioned GTG Class. **Non-Sanc**

Class 113 **Other Breed Go-To-Ground – over 12 ½" (Non-Sanctioned)** – Open to any breed other than a JRT, under 30 lbs. May Not cross-enter with any Sanctioned GTG Class. **Non-Sanc**

No adult terrier may compete in any GTG or Super Earth Certificate class unless a JRTCA Trial Certificate has been applied for, issued, AND presented to the Trial Secretary with the submission of entry forms or at the trial.

Section 2. GO-TO-GROUND CHAMPION CERTIFICATE

CROSS-ENTERING IS NOT PERMITTED BETWEEN CERTIFICATE CLASSES

Class 114 **10" up to 12 ½" Championship Certificate** – Open to any adult Jack Russell, 10" up to 12½", 1 year and older, which holds a JRTCA Trial Certificate. A copy of the certificate must be submitted with pre-entry or be shown to the Den Steward at the time of the class. First and second place winners will be Go-To-Ground Champion and Reserve. (One second per foot of tunnel to reach quarry; may leave earth once and re; may not leave earth; work quarry for one full minute without a break in work and without leaving quarry.)

Class 115 **Over 12 ½ up to 15" Championship Certificate** – Open to any adult Jack Russell, 12½" up to 15", 1 year and older, which holds a JRTCA Trial Certificate. A copy of the certificate must be submitted with pre-entry or be shown to the Den Steward at the time of the class. First and second place winners will be Go-To-Ground Champion and Reserve. (One second per foot of tunnel to reach quarry; may leave earth once and re; may not leave earth; work quarry for one full minute without a break in work and without leaving quarry.)

Class 116 **10" up to 12 ½" Veteran Championship Certificate** – Open to any adult Jack Russell, 10" up to 12½", 6 years of age or older, which holds a JRCTA trial certificate. A copy of the certificate must be submitted with pre-entry or be shown to the Den Steward at the time of the class. **CROSS-ENTERING IS NOT PERMITTED BETWEEN CERTIFICATE CLASSES.** (One second per foot of

tunnel to reach quarry; may leave earth once and re; may not leave earth; work quarry for one full minute without a break in work and without leaving quarry.)

- lass 117 **Over 12 ½” up to 15” Veteran Championship Certificate** – Open to any adult Jack Russell, 10” up to 12½”, 6 years of age or older, which holds a JRCTA trial certificate. A copy of the certificate must be submitted with pre-entry or be shown to the Den Steward at the time of the class. CROSS-ENTERING IS NOT PERMITTED BETWEEN CERTIFICATE CLASSES. (One second per foot of tunnel to reach quarry; may leave earth once and re; may not leave earth; work quarry for one full minute without a break in work and without leaving quarry.)
- Class 118 **10” up to 12.5” Senior Champion Certificate** – Open to any adult Jack Russell, 9 years of age or older, which holds a JRCTA trial certificate. A copy of the certificate must be submitted with pre-entry or be shown to the Den Steward at the time of the class. CROSS-ENTERING IS NOT PERMITTED BETWEEN CERTIFICATE CLASSES. (One second per foot of tunnel to reach quarry; may leave earth once and re; may not leave earth; work quarry for one full minute without a break in work and without leaving quarry.)
- Class 119 **Over 12.5” up to 15” Senior Champion Certificate** – Open to any adult Jack Russell, 9 years of age or older, which holds a JRCTA trial certificate. A copy of the certificate must be submitted with pre-entry or be shown to the Den Steward at the time of the class. CROSS-ENTERING IS NOT PERMITTED BETWEEN CERTIFICATE CLASSES. (One second per foot of tunnel to reach quarry; may leave earth once and re; may not leave earth; work quarry for one full minute without a break in work and without leaving quarry.)

DIVISION E: SUPER EARTH

Section 1. Open Super Earth **(SANCTIONED, unless otherwise noted)**

A challenging GTG course with a series of false entrances and/or false tunnels and dens. Open to any Jack Russell Terrier, 6 months and older. One second per foot of tunnel to reach quarry; may leave and re-enter earth several times until the quarry is reached; must work quarry for one full minute without a break in work and without leaving quarry. May switch from one type of work to another without penalty.

Open Super Earth Classes are NOT Champion Classes. *You must pass the Open class and submit your paperwork to the JRTCA to compete in the Super Earth Certificate Classes at future trials.*

- Class 120 **6 up to 12 months Puppy Super Earth** – 6 up to 12 month Open Puppy Super Earth. Puppies earning a score of 100% at this trial may, upon payment of the entry fee, enter the Puppy Champion Super Earth class at this trial. ONCE A PUPPY ENTERS THE PUPPY CHAMPION SUPER EARTH CLASS IT CAN NOT ENTER IN OPEN PUPPY SUPER EARTH CLASS AT ANY FUTURE TRIAL.
- Class 121 **10” – 15” Adult Super Earth** – Open to adult terriers one year and older.
- Class 122 **10” – 15” Veteran Super Earth** – Open to veteran terriers 6 years and older.
- Class 123 **10” – 15” Senior Super Earth** – Open to senior terriers 9 years and older.
- Class 124 **Other Breed Super Earth – up to 12 ½" (Non-Sanctioned)** – Open to any breed other than a JRT, under 30 lbs. May Not cross-enter with any Sanctioned GTG Class. **Non-Sanc**

- Class 125 **Other Breed Super Earth – over 12 ½" (Non-Sanctioned)** – Open to any breed other than a JRT, under 30 lbs. May Not cross-enter with any Sanctioned GTG Class. **Non-Sanc**
- Class 126 **Novice Super Earth** – Open to any terrier that has never entered or passed a Super Earth class at this, or any other trial. **You may NOT cross enter or bump up into any other Super Earth Class at this trial.** (Non-Sanctioned) **Non-Sanc**

Section 2. SUPER EARTH CERTIFICATE CLASSES (SANCTIONED)

No Cross-Entering Between Open and Certificate Classes

Open to adult Jack Russells one year and older which hold a **JRTCA SUPER EARTH TRIAL CERTIFICATE**. A copy of the Certificate must be submitted with pre-entry or shown to Registration Desk with post-entry. First and second place winners will be Super Earth Champion and Reserve. ***(One second per foot of tunnel to reach quarry; may leave and re-enter earth several times until the quarry is reached; must work quarry for one full minute without a break in work and without leaving quarry. May switch from one type of work to another without penalty.)***

- Class 127 **6 up to 12 Month Puppy Championship Super Earth** – Open to 6 up to 12 month JRT puppies which have earned 100% in an Open 6 up to 12 Month Super Earth Puppy Class at this or a previous JRTCA Trial. A copy of a 100% score sheet must be presented with Pre-Entry or be shown to the Den Steward at the time of the class. First and second place winners will be Puppy Super Earth Champion and Reserve.
- Class 128 **10" up to 12.5" Adult Champion Super Earth Certificate** – Open to adult Jack Russells one year and older, which hold a JRTCA Super Earth Trial Certificate.
- Class 129 **Over 12.5" up to 15" Adult Champion Super Earth Certificate** – Open to adult Jack Russells one year and older which hold a JRTCA Super Earth Trial Certificate.
- Class 130 **10" up to 12.5" Veteran Champion Super Earth Certificate** – Open to adult Jack Russells 6 years and older, which hold a JRTCA Super Earth Trial Certificate.
- Class 131 **Over 12.5" up to 15" Veteran Champion Super Earth Certificate** – Open to adult Jack Russells 6 years and older, which hold a JRTCA Super Earth Trial Certificate.
- Class 132 **10" up to 12.5" Senior Champion Super Earth Certificate** – Open to adult Jack Russells 9 years and older, which hold a JRTCA Super Earth Trial Certificate.
- Class 133 **Over 12.5" up to 15" Senior Champion Super Earth Certificate** – Open to adult Jack Russells 9 years and older, which hold a JRTCA Super Earth Trial Certificate.

DIVISION F: TRAILING & LOCATING

Trailing & Locating involves the terrier tracking and locating a quarry (above ground). The terrier is judged on his ability to follow a line in a simulated natural hunting environment, to locate, mark and open on quarry. The terrier is judged on a combination of time and accuracy. The terrier with the fastest time is not necessarily the winner.

Section 1. Trailing & Locating (SANCTIONED)

- Class 134 **Puppies**, 6 up to 12 months
- Class 135 **Adults**, 1 year and older
- Class 136 **Veterans**, 6 years and older
- Class 137 **Seniors**, 9 years and older
- Class 138 **TRAILING & LOCATING CHAMPION & RESERVE** Two best times of the day from classes 134-137. No entry fee.

Section 2. Trailing & Locating (NON-SANCTIONED)

This event is for any breed other than a JRT, i.e., Colored Terriers/Working Breeds, etc. May NOT cross-enter with any Sanctioned Trailing & Locating Classes

- Class 139 **Other Breed**, Open to any breed other than a JRT, 6 months and older. **Non-Sanc**

DIVISION G: BRUSH HUNT PLUS

(NON-SANCTIONED)

Your dog will run in an area with straw bales, cardboard boxes, garbage bags filled with paper, other common things found in your garage or yard, and an agility tunnel. When the judge calls you and your dog into the ring, you'll enter and go straight to the start area. You will wait there until the Judge says it is OK to start. You'll then remove your dog's collar and leash and release your dog. Your time starts when your dog's or your feet leave the start area. During the 2:00 minute maximum run time your dog will be required to find the rat, go through the agility tunnel, and climb up on anything in the ring stable enough for them to climb on. The three requirements can be completed in any order. You may encourage you dog to move anywhere in the ring but you may not touch your dog, any items in the ring, or step over anything until they find the rat. Time stops when all the requirements are completed or the 2:00 minutes are up. Placement will be based on time.



There will be three hidden rat containers made of PVC pipe in the ring during each run. One will be empty, one will contain rat litter, and one will hold the rat.

When your dog finds the rat, you must let the Judge know by clearly calling RAT. If the Judge confirms that it is the rat praise your dog for doing the right thing then restrain your dog while the rat is moved to safety. You may then release your dog to finish any remaining requirements. If the Judge says the call is not a rat, your run is done and an NQ score will be assessed.

- Class 140 **Puppies**, 6 up to 12 months **Non-Sanc**
- Class 141 **Adults**, 1 year and older **Non-Sanc**
- Class 142 **Veterans**, 6 years and older **Non-Sanc**
- Class 143 **Seniors**, 9 years and older **Non-Sanc**
- Class 144 **BRUSH HUNT CHAMPION & RESERVE** Two best times of the day from classes 140-143. No entry fee. **Non-Sanc**
- Class 145 **Other breed**, Open to any breed other than a JRT, 6 months and older. **Non-Sanc**

DIVISION H: URBAN WARFARE

(NON-SANCTIONED)

Urban Warfare is a controlled hunting scenario designed with the JRT in mind. It's a great way to test hunting ability without risk to the dog's safety. The terrier must navigate the course in search of hidden quarry, demonstrating to the judge an intelligent use of its sight, smell and hearing. Time starts when paws touch the ground and stops when the handler believes they have located the quarry. That's when the fun begins. **Champion and Reserve are based on judge's choice, not on time. (Non-Sanctioned)**

Class	146	Puppies , 6 up to 12 months	Non-Sanc
Class	147	Adults , 1 year and older	Non-Sanc
Class	148	Veterans , 6 years and older	Non-Sanc
Class	149	Seniors , 9 years and older	Non-Sanc
Class	150	URBAN WARFARE CHAMPION & RESERVE Judge's choice. No entry fee.	Non-Sanc
Class	151	Other breed , Open to any breed other than a JRT, 6 months and older.	Non-Sanc

DIVISION I: GAMES

(All Games are NON-SANCTIONED)

Go Fish

From behind the line, send your dog in search of a new toy. Time starts when you release your dog and ends when they have selected a toy and brought it back across the starting line. They do not need to give the toy to you. Best Time Wins. As an added bonus, each toy is marked and you could potentially win a small prize. 3-minute time limit.

Class	152	Puppies , 4 up to 12 months	Non-Sanc
Class	153	Adults , 1 year and older	Non-Sanc
Class	154	Veterans , 6 years and older	Non-Sanc
Class	155	Seniors , 9 years and older	Non-Sanc
Class	156	Other breed , Open to any breed other than a JRT, 6 months and older.	Non-Sanc

Treat Seeking Missile

8 Solo cups in two rows of 4. Treats will be hidden under 3 of the cups. Dogs have 60 seconds to find all three treats. Fastest time wins. Each entrant will be given a treat at the start of the class so the dog knows what they are looking for. No speaking, or directing them where to look, this is all up to your dog. Dogs with special dietary needs can bring their own treats

Class	157	Puppies , 6 up to 12 months	Non-Sanc
Class	158	Adults , 1 year and older	Non-Sanc
Class	159	Veterans , 6 years and older	Non-Sanc
Class	160	Seniors , 9 years and older	Non-Sanc
Class	161	Other breed , Open to any breed other than a JRT, 6 months and older.	Non-Sanc

Ball Toss

From behind the line, the handler throws the ball past the line. Dog is to retrieve and bring the ball back across the line. They do not have to bring the ball to hand. Best time out of 3 try's determines the winner.

Class 162	Puppies , 6 up to 12 months	Non-Sanc
Class 163	Adults , 1 year and older	Non-Sanc
Class 164	Veterans , 6 years and older	Non-Sanc
Class 165	Seniors , 9 years and older	Non-Sanc
Class 166	Other breed , Open to any breed other than a JRT, 6 months and older.	Non-Sanc



DIVISION J: SPECIAL WEEKEND HIGH POINTS

*****NO ENTRY FEES***
(Non-Sanctioned)**

There's **NO ENTRY FEE** to enter the High Point classes. The more classes you enter, the more points your dog can earn! A score sheet will be included in your registration packet. You are responsible for keeping track of your points, which may be checked by the Trial Administrator in case of dispute. Please have your score sheets completed & turned in to the trial secretary, Sunday by 4:00 PM. (No cross entering between high point classes 167-173. You may cross enter into high point classes 174 & 175)

- Class 167 **Puppy High Point** – Open to Puppies 6-12 months. MUST compete in a Puppy Conformation class (Division C), plus at least four additional classes from these events: Go-to-Ground, Super Earth, Racing Flats, Racing Hurdles, Trailing & Locating, Brush Hunt, and Urban Warfare
- Class 168 **Adult Terrier High Point** – Open to adult Terriers 1 year and older, MUST compete in Working or Open Conformation (Division C), plus at least four additional classes from these events: Go-to-Ground, Super Earth, Racing Flats, Racing Hurdles, Trailing & Locating, Brush Hunt, and Urban Warfare.
- Class 169 **Veteran High Point** – Open to Terriers 6 years and older only. MUST compete in the Veteran Terrier conformation class (or equivalent), plus at least four additional classes from these events: Go-to-Ground, Super Earth, Racing Flats, Racing Hurdles, Trailing & Locating, Brush Hunt, and Urban Warfare
- Class 170 **Senior High Point** – Open to Terriers 9 years and older only. MUST compete in the Veteran conformation class (or equivalent), plus at least four additional classes from these events: Go-to-Ground, Super Earth, Racing Flats, Racing Hurdles, Trailing & Locating, Brush Hunt, and Urban Warfare
- Class 171 **Companion/Rescue High Point** – Open to Spayed & Neutered Terriers and Rescued Terriers. Dogs MUST compete in the Spayed/Neutered Class or the Companion & Rescue Terrier Conformation Class, plus at least four additional classes from these events: Go-to-Ground, Super Earth, Racing Flats, Racing Hurdles, Trailing & Locating, Brush Hunt, and Urban Warfare

- Class 172 **Novice Terrier/Handler High Point** – Open to Novice Adult Terriers & Novice Handlers, where the Gemboree is their FIRST trail experience. Points are accumulated through the following classes: Conformation Class 93, Go-To-Ground Class 107 or 110, Super Earth Class 126, Trailing & Locating, Brush Hunt, Urban Warfare, and Racing.
- Class 173 **Other Breed High Point** – Open to any breed other than a JRT. Your dog must compete in a minimum of five (5) events, both days, from the ‘other breed’ classes listed.
- Class 174 **Games Master High Point** – Open to dogs that compete in all three Division I Games. Highest accumulation of points from the 3 games over BOTH DAYS will be Champion and Reserve. May cross enter between this class & any other high point.
- Class 175 **Terrier Terra Triumph!** – Test your terrier’s tracking & gaming skills and have some fun doing it! Open to dogs 6 mo & older. To be eligible, dogs MUST compete in ALL of the following: GTG, SE, T&L and Brush Hunt, BOTH days. Champion & Reserve will be the highest combined scores from the weekend; to be awarded Sunday. Ties will be settled by best time in GTG. (Times & placements from GTG do not include the novice tunnel). May cross enter between this class & any other high point. Score sheet will be in registration packet. **No Entry Fee!**



*In Memory of
Windy of Promised Land*

For ****ALL**** weekend High Point awards, points assigned for first through sixth, will be as follows: **1st = 8 points; 2nd = 6 points; 3rd = 5 points; 4th = 4 points; 5th = 3 points; 6th = 2 points; and participation = 1 point.** For example, if you place 3rd in Spayed/Neutered Terrier, you would give yourself one point for participation and 4 points for your placement, for a total of 5 points for that class. Championships, Bests, & High Scores do NOT count for points, (this does not apply to certificate championship classes, such as GTG & Super Earth).



**Get your 50/50
Raffle Tickets!**

**50 % to TSJRTC and 50% (Split 60/40)
to the 1st & 2nd Place Winners**

**\$10 per ticket - no limit to how big the
pot can grow!**

**Get yours online at
www.tristatejackrussellclub.com or at
the trial.**

Raffle will be called Sunday at 3:30.

PLEASE REMEMBER TO BRING A COPY OF EACH DOG'S PEDIGREE THAT IS GETTING BLOOD DRAWN



**INDIVIDUAL GENETIC DATA FORM
JACK RUSSELL TERRIER RESEARCH FOUNDATION**

“Working for Future Generations”

www.JRTHealthRegistry.com

INSTRUCTIONS: PLEASE PRINT CLEARLY. KEEP PINK COPY for your records.

Attach a copy of the pedigree and any medical diagnosis (i.e. CAER/CERF, BAER) to this form.

www.JRTHealthRegistry.com to submit Health and Genetic test results

Terrier Information

Date of DNA Submission: _____ New: Updated Information: (Please check one)
 Terrier's Full Name (incl. Kennel): _____ Reg. # _____
 Date of Birth: _____ Sex: _____ Color: _____ Coat: _____ Height: _____
 Breeder's Name: _____
 Sire: _____ Reg. # _____
 Dam: _____ Reg. # _____

Terrier's Tests and Forms (Please attach copies of test results or you may mail them later)

CAER/CERF Date (mm/yy) _____ Result: Normal Other _____ Diagnosis _____
 BAER Date (mm/yy) _____ Result: Normal Other _____ Diagnosis _____
 Other Tests & Diagnosis _____

Terrier Health History (Has any condition been diagnosed in this terrier?)

Condition: _____ Age First Suspected: _____ Age Diagnosed: _____
 Condition: _____ Age First Suspected: _____ Age Diagnosed: _____

Family History (Has any condition been diagnosed in other family members?)

Relationship & Name: _____ Condition: _____ Age Diagnosed: _____
 Relationship & Name: _____ Condition: _____ Age Diagnosed: _____
 Relationship & Name: _____ Condition: _____ Age Diagnosed: _____

Comments (Additional history and pertinent information)

Owner's Information & Consent

Name: _____ Email: _____
 Address: _____
 City: _____ State: _____ Zip: _____
 Phone: _____ Cell: _____

This information is complete and accurate. I am releasing it and this terrier's DNA sample to the Jack Russell Terrier Research Foundation, which may use it on a confidential basis for genetic research purposes. I understand the identity of dogs and owners participating in the research will not be revealed.

Owner's Signature: _____ Date: _____

For questions: DNA Bank: Debbie Johnson: (770) 427-1618 or (404) 539-0155 (cell); Debbie@jrt-research.com

Send **WHITE COPY**, Pedigree and related medical documents to:

Send **YELLOW COPY**, Pedigree and DNA Sample to:
 JRTRFDNA Bank
 c/o Dr. Gary Johnson
 320 Conaway Hall, University of Missouri
 Columbia, MO 65211

KEEP PINK COPY FOR YOUR RECORDS

Tri-State Jack Russell Terrier Club

Preserve, Protect, and Work the Jack Russell Terrier

The Tri-State Jack Russell Terrier Club (TSJRTC) is an Affiliate Club of the Jack Russell Terrier Club of America, Inc. (JRTCA), and abides by all objectives and purposes stated by the JRTCA constitution and bylaws.



TRI-STATE
JACK RUSSELL TERRIER CLUB

2022 MEMBERSHIP APPLICATION

- Renewal New Membership
 \$20 – Single, 1 Year (Jan 1 – Dec 31) \$30 – Family, 1 Year (Jan 1 – Dec 31)

Please mail completed application and check payable to TSJRTC to:

TSJRTC
c/o Cheryl Costello
481 Barbara Dr.
Grants Pass, OR 97526

Or if paying via PayPal*, email completed application to: info@tristatejackrussellclub.com

*If paying by PayPal, a completed application must still be submitted to the TSJRTC Membership Secretary.

NAME: _____
ADDRESS: _____
CITY: _____ STATE: _____ ZIP: _____
PHONE: _____ EMAIL: _____

The Tri-State Jack Russell Terrier Club is for you, the members; please let us know what your areas of interest are? Also, if there are any areas where you would like to volunteer?

- Fun Days Trials Committee
- | | |
|--|---|
| <input type="checkbox"/> Setup/Teardown | <input type="checkbox"/> Racing |
| <input type="checkbox"/> Check-In | <input type="checkbox"/> Conformation |
| <input type="checkbox"/> Hospitality | <input type="checkbox"/> GTG/SE |
| <input type="checkbox"/> Raffle | <input type="checkbox"/> Brush Hunt/Trailing & Locating |
| <input type="checkbox"/> Obedience/Rally | <input type="checkbox"/> Agility |
| <input type="checkbox"/> Youth | <input type="checkbox"/> Other: _____ |

I/We hereby apply for membership in the TSJRTC and agree to abide by the objectives and purposes set forth, and that I/We do not belong to a conflicting JRT organization, nor have registered my Jack Russell Terrier(s) with any other kennel club.

SIGNATURE

DATE

SIGNATURE

DATE

www.tristatejackrussellclub.com

info@tristatejackrussellclub.com

CLASS SPONSORSHIP FORM - SATURDAY

Please support the Tri-State Club by sponsoring one or more classes of your choice.

The cost is \$12.00 per Class or \$30 for 3 Classes; \$25.00 for Best/Championship; \$50.00 for a Division.

(Please List Three Classes In Order Of Preference)

Kennel or Business: _____

Name: _____

Address: _____

Saturday Class Preference:

(1) _____ (2) _____ (3) _____

Best/Championship _____ Division _____

Sponsor Amount \$ _____

CLASS SPONSORSHIP FORM - SUNDAY

Please support the Tri-State Club by sponsoring one or more classes of your choice.

The cost is \$12.00 per Class or \$30 for 3 Classes; \$25.00 for Best/Championship; \$50.00 for a Division.

(Please List Three Classes In Order Of Preference)

Kennel or Business: _____

Name: _____

Address: _____

Sunday Class Preference:

(1) _____ (2) _____ (3) _____

Best/Championship _____ Division _____

Sponsor Amount \$ _____

Thank You to all of Our Sponsors!

Glenwood
Pet Awnings

Quality covers for exercise pens



Glenwood-petawnings.com

Keep your dog cool, covered and ready to show with a Glenwood Exercise Pen Cover! (541)479-5679
glenwoodpetawnings@live.com



the Leading Lady

HANDMADE LEADS & COLLARS



Kelly Melberg

360-219-6691
Facebook: @leadingladyleads

CUSTOM ORDERS ACCEPTED

- * Tie-Out Hunting leads
- * Splitters
- * Martingales
- * Slip Leads & Collars
- * Puppy Leads
- * Show Leads

ALL PRODUCTS MADE FROM SOFT, DURABLE BETA BIOTHANE

★ **Bulletproof Jacks** ★

JRTCA Working Jack Russell Terriers

Kelly Melberg (360) 219-6691

www.bulletproofjacks.com
outridin@gmail.com

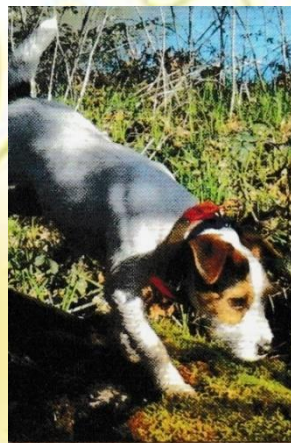

West End

VII & VIII

Mardi Paws Style



September 24 & 25 2022

Valley of the Rogue State Park
Gold Hill, OR 97525

P Mardi Paws



TWO 'A' RATED TRIALS

ONE TERRIERIFIC GOOD TIME

Conformation Racing Go-To-Ground

Super Earth Clear Instinct

Games & More



www.westendjrt.com

West End Wishes You A Safe & Fun Trial Season

CALIFORNIA COMMOTION

VII &

Two A-rated



VIII

JRTCA trials

October 29 & 30, 2022

at the International Agri-Center in Tulare CA

Featuring

Conformation
Go To Ground
Brush Hunt
Agility
Obedience

Racing
Super Earth
Trailing & Locating
Rally-O
Terrier Games

Trial Chair:

Jill-Marie Jones | jmjones3874@gmail.com | (714) 917-9628

Supporting Russell Rescue CA

**THE GEM DANDY JACK RUSSELL TERRIER TEAM,
DARBY, TEAGAN, AND PEDEY**

**WISH YOU ALL THE BEST OF LUCK AT THE
2022 TREASURE VALLEY GEMBOREE!**



Robert and Susan Getty

GEMDANDYJRT@GMAIL.COM – (208) 297-9122



*Forget Me Not
Boarding Kennels*

Peaceful Country Setting

* Large and clean kennels * Exercise yard * Grooming available for small dogs
* Reasonable prices

Lynn Hawley
Emmett, Idaho
www.forgetmenotjrt.com

Cell: 208-365-1729
Home: 208-365-4030
lynn@forgetmenotjrt.com

JRTCA Jack Russell Terrier Breeder

Promised Land

JACK RUSSELLS

*Wishing everyone safe
travels, a fun trial,
& lasting friendships!*

PLRJACKS@GMAIL.COM

*Thank you to the
exhibitors, those that
support the club, and
all the little white dogs!*